

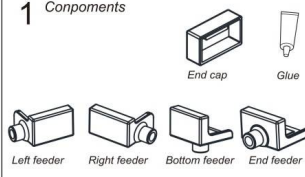

3D Neon Cutting and Connection Guide

1 Components



2 Cut and preparation

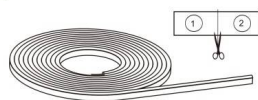

1. Cut directly in the middle distance between the two lenses;
2. The cutting surface should be smooth and vertical;

3 Install Endcap

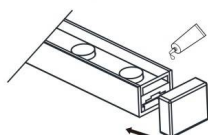

Seal the strip and end cap by glue, then fix it for 24hours

4 Remove the silicone at back

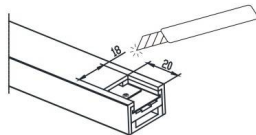

6. Fix cable on PCB by soldering

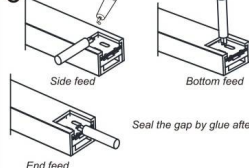

Seal the gap by glue after soldering

7 Install feeder by silicone glue

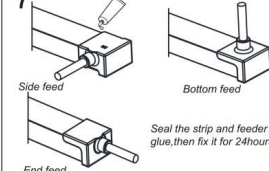

Seal the strip and feeder by glue,then fix it for 24hours

Installation Guide

1 Mounting accessories



2 Mounting accessories



3 Connect wire as required

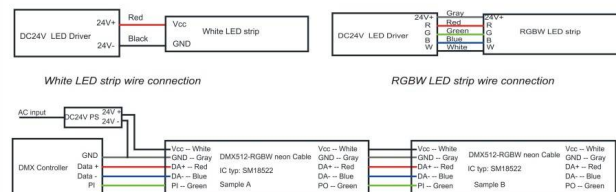

4 Installation and warning

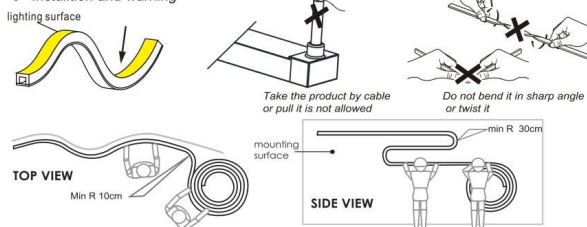

For assembly of LED flex neon longer than 2m carefully handling with min. 2 employees is necessary. The electrical circuit could be damaged if bending radius is too small. Stainless steel core and resincan not avoid any damage by inadequate handling.